



User manual

eConnect

B*



Document no.:		Subject to technical modifications without prior notification and to errors. Reproduction, even in part, only permitted with permission from Veigel GmbH + Co. KG
Created:	05.08.2025	
Author:	Bürker	
Revised:		
Version:	1	

Revision history	6
General information	7
Symbols used	7
Veigel hotline	7
General safety instructions	8
Observe the following in particular during assembly:	8
Observe the following in particular as a user:	9
Product description	10
Function	10
Hand control	10
VEA electronics kit	10
Type plate	10
Scope of delivery Hand control Push Pull	11
Scope of delivery Hand control Push Right Angle	12
Scope of delivery Hand control Push Rock	13
Available accessories	14
Push Pull Basic Grip	14
Push Pull V360 Grip	14
Push Right Angle Basic Grip	15
Premium Horizontal Grip with buttons	16
Premium Vertical Grip with buttons	17
Premium Vertical without buttons	18
Scope of delivery Electronics kit VEA	19
Scope of delivery Electronics kit VAS	20
Universal adapter cable set	21
Intended use	22
Operation	23
Safety information	23
Push pull operating concept	24
Brake:	24
Accelerate:	24
Push Right Angle operating concept	25
Brake:	25
Accelerate:	25
Push Rock operating concept	26
Brake:	26
Accelerate:	26
Operation of the electronic switchover VEA	27

Mode 1:	27
Mode 2:	27
VEA mode setting	27
Operation of the electronic switchover VAS	29
Mode 5:	29
Mode 6:	29
Mode setting VAS	29
Mounting	32
Tightening torques	32
Safety information	32
Adjust bearing	33
Install brake linkage	34
Adjust brake linkage	35
Adjust handle angle	36
Installation	38
Schematic representation of the cable set VEA	38
Installation VEA	38
Schematic representation of the cable set VAS	42
Installation of the VAS control system	42
Function test VAS	43
Notes	44
Disassembling the product	44
Disposal	44
Functional check	44
Transport and storage	44
Reusing the product	44
Maintenance and care	44
Installation record	46
Approval	47

Revision history

Edition	Change	Chapter
1	Initial version	

General information

Symbols used

The following symbols are used in these operating instructions:



This symbol refers to information that, if not observed, will pose a risk to your health or the functionality of the device.



This symbol refers to important additional information.



This symbol refers to tips and recommendations.

Individual images contained in these instructions may deviate from the dual control you received.

Veigel hotline

Veigel GmbH + Co. KG	Telephone:	+49 7941 60585 0
Verrenberger Weg 36	E-mail:	info@veigel-automotive.de
D-74613 Öhringen	Website:	http://www.veigel-automotive.de/
	Support Mail:	[[[Nicht definierte VariableUnternehmen.Support Mail]]]
	Support Phone:	[[[Nicht definierte VariableUnternehmen.Support tel]]]

General safety instructions

The driving aid is a ready-to-install assembly kit. It has been designed and built in accordance with carefully selected harmonized standards and other technical specifications. It therefore complies with the state of the art and ensures maximum safety during operation. The driving aid left the factory in a condition that is safe from a technical standpoint.

However, safety can only be ensured in practice if all necessary measures are taken. It is the operator's duty of care to plan these measures and monitor their implementation.



Do not use the hand control as an entry aid!

Observe the following in particular during assembly:

- Installation and maintenance work may only be carried out by qualified personnel using suitable tools!
- Read these installation and operating instructions carefully before installing the driving aid.
- Hand over any parts certificate for the driving aid to the customer together with the vehicle.
- The corresponding installation or operating instructions can be found in our download area.
- Observe the applicable accident prevention and safety regulations during installation and maintenance of the driving aid!
- When installing the driving aid in an authorized workshop, the "Installation record" auf Seite 46 at the end of the installation instructions must be completed. For factory installation, a separate installation report is created and archived at the Veigel factory.
- Only accessories available from the manufacturer may be used for manual operation.

Download area:



Observe the following in particular as a user:

- Comply with generally accepted codes of practice when using and operating the driving aid!
- Observe the applicable accident prevention and safety provisions when operating the driving aid!
- The driving aid may only be operated if it is in a flawless, functional condition. Arrange for functional faults to be remedied immediately.
- Only use the driving aid with the type(s) of vehicle for which it is intended (see Intended use).
- Always keep the complete installation and operating instructions inside the vehicle.
- If the vehicle is not driven by a disabled person, then the driving aid must be removed or taken out of operation. Details can be found in the operating instructions.



The driving aid features built-on parts and levers that will restrict the space available on the driver's side to a certain extent once installed.



If this information is not observed, this will void the warranty, the manufacturer's liability and, in certain situations, the type approval. As a consequence, no claims can then be made against us.

Product description

Function

Hand control

The eConnect hand controls are mounted below the steering column and enable people with physical impairments to operate the accelerator and brake with one hand. Depending on the operating concept, the direction of movement for the accelerator changes. To brake, the hand control must always be pushed forward.

VEA electronics kit

The VEA electronics kit consists of a cable set that is connected to the original accelerator pedal via the safety electronics.

Before driving, you must decide whether to use the original accelerator pedal or the Veigel hand control. While driving, the electronics prevent switching between the original accelerator pedal and the hand control.

When the driving aid is activated, the original accelerator pedal can be pressed all the way down, but it has no function.

When the original accelerator pedal is activated, the Veigel hand control has no function.



When ordering the hand control, please provide all necessary vehicle data to ensure you receive the correct control and cable set.

Type plate

Veigel GmbH + Co. KG 74613 Öhringen

Type: Version: B*

Type designation:

Factory no.: xxxxxx-xxx

Article no.: B*

Type designation: Registration number (type approval)

Factory no.: Unique serial number

Article no.: Unique order number



You will find the type plate either affixed to a component of the scope of delivery and/or on the packaging of the driving aid.



The type plate with the factory number are important when it comes to uniquely identifying the scope of delivery.

Scope of delivery Hand control Push Pull

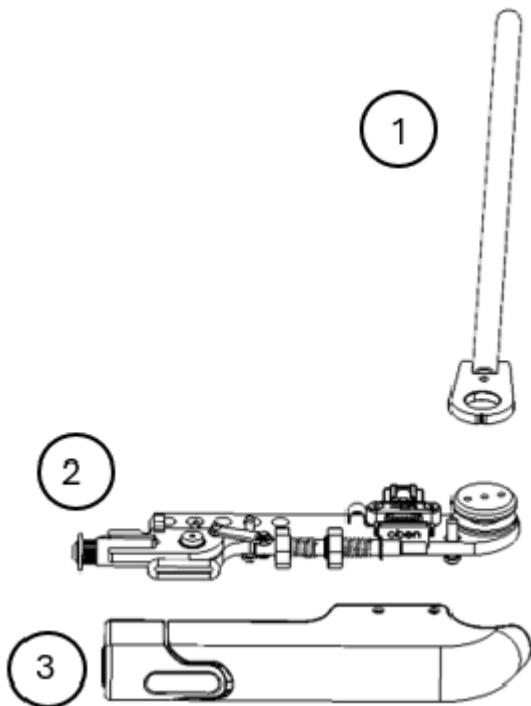

1	Main Shaft
2	Base unit Hand control
3	Cover

eConnect push-pull handle to the left of the steering wheel	eConnect push-pull handle to the right of the steering wheel
BHLE-01-XX-XXXX	BHRE-01-XX-XXXX

	When ordering the hand control, please provide the vehicle data to ensure you receive the correct product.
---	--

- The hand control is completely pre-assembled and adjusted.
- The cable set **must** be ordered separately for your specific vehicle.
- For the push-pull version, a handle **must** be ordered **separately**.

Scope of delivery Hand control Push Right Angle

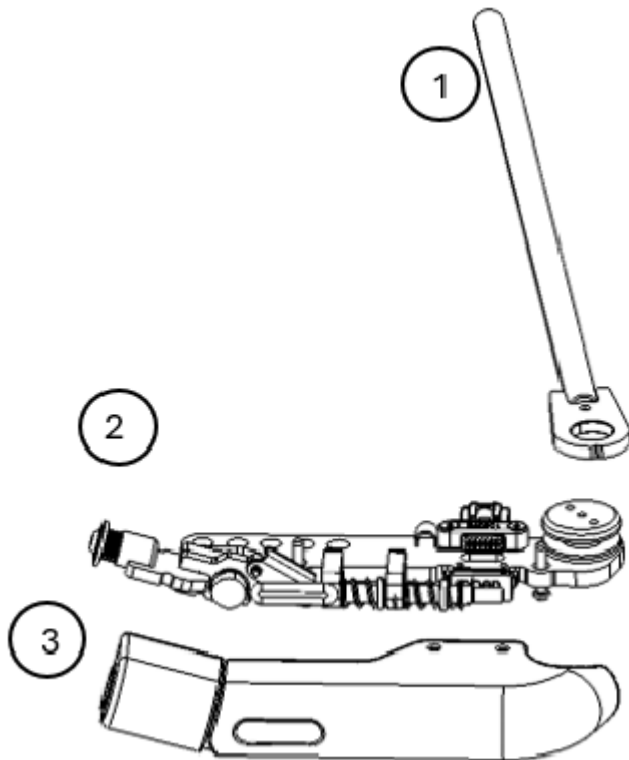

1	Main Shaft
2	Base unit Hand control
3	Cover

eConnect Push Right Angle handle to the left of the steering wheel	eConnect Push Right Angle Griff rechts neben dem Lenkrad
BHLE-02-XX-XXXX	BHRE-02-XX-XXXX

	<p>When ordering the hand control, please provide the vehicle data to ensure you receive the correct product.</p>
---	---

- The hand control is completely pre-assembled and adjusted.
- The cable set **must** be ordered separately for your specific vehicle.
- For the push-pull version, a handle **must** be ordered **separately**.

Scope of delivery Hand control Push Rock

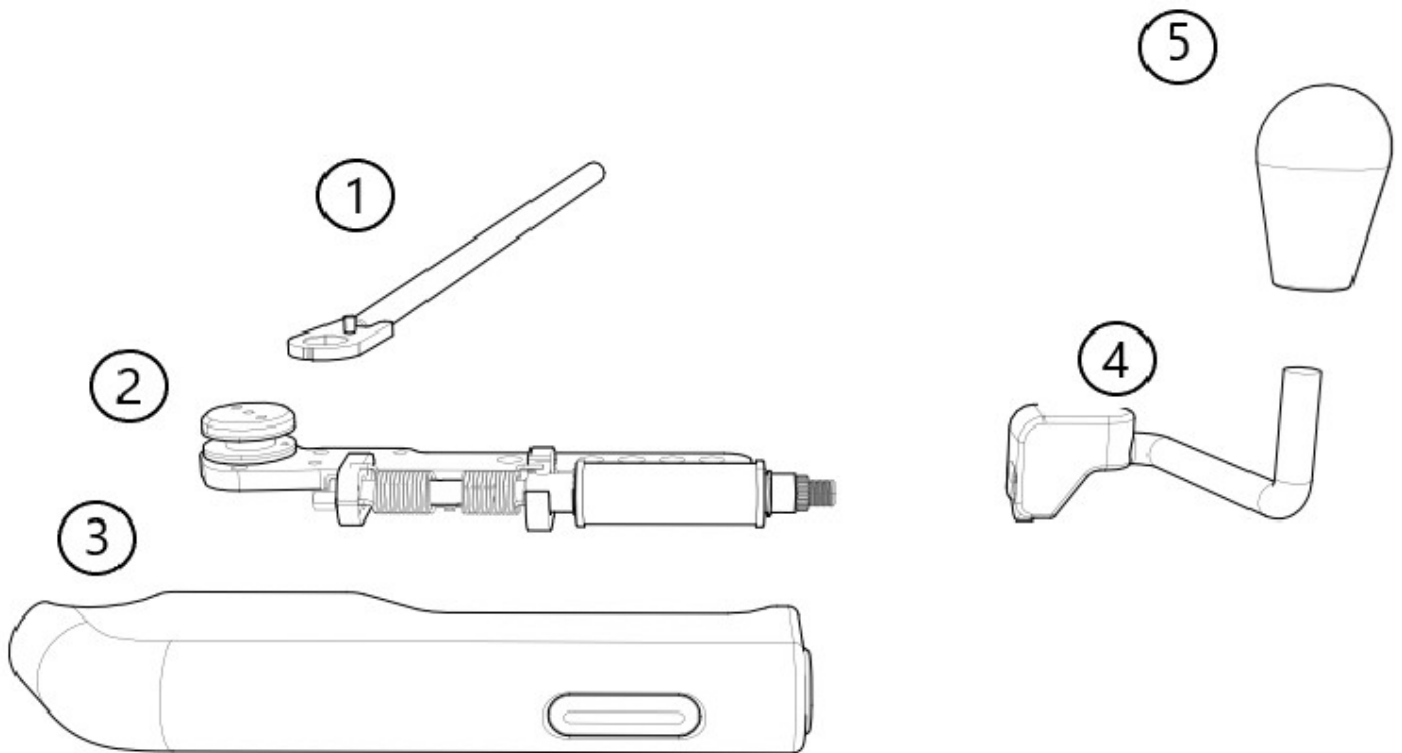

1	Main Shaft
2	Base unit Hand control
3	Cover
4	Handle with cover
5	Grip

eConnect Push Rock handle to the left of the steering wheel	eConnect Push Rock handle to the right of the steering wheel
BLH000XX	BRH000XX



When ordering the hand control, please provide the vehicle data to ensure you receive the correct product.

- The hand control is completely pre-assembled and adjusted.
- The cable set **must** be ordered separately for your specific vehicle.

Available accessories

Push Pull Basic Grip

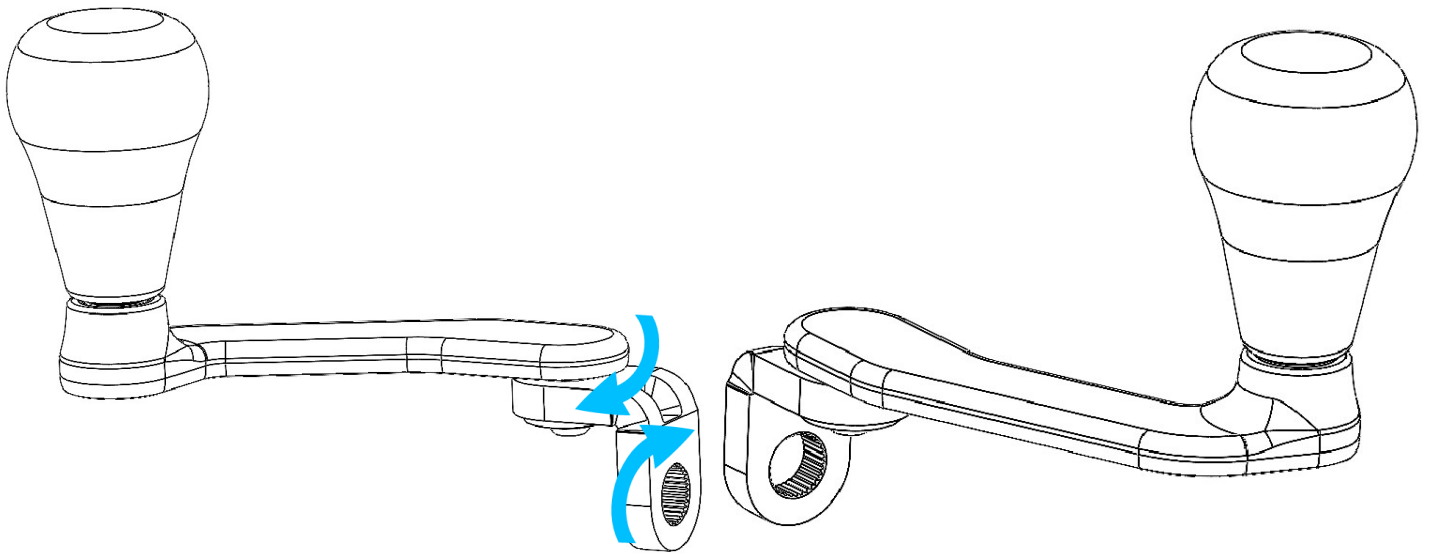

- Compatible with eConnect2 Push Pull
- Available in left and right versions
- 2 adjustable axes
- Left side **Z04363**
- Right side **Z04362**

Push Pull V360 Grip

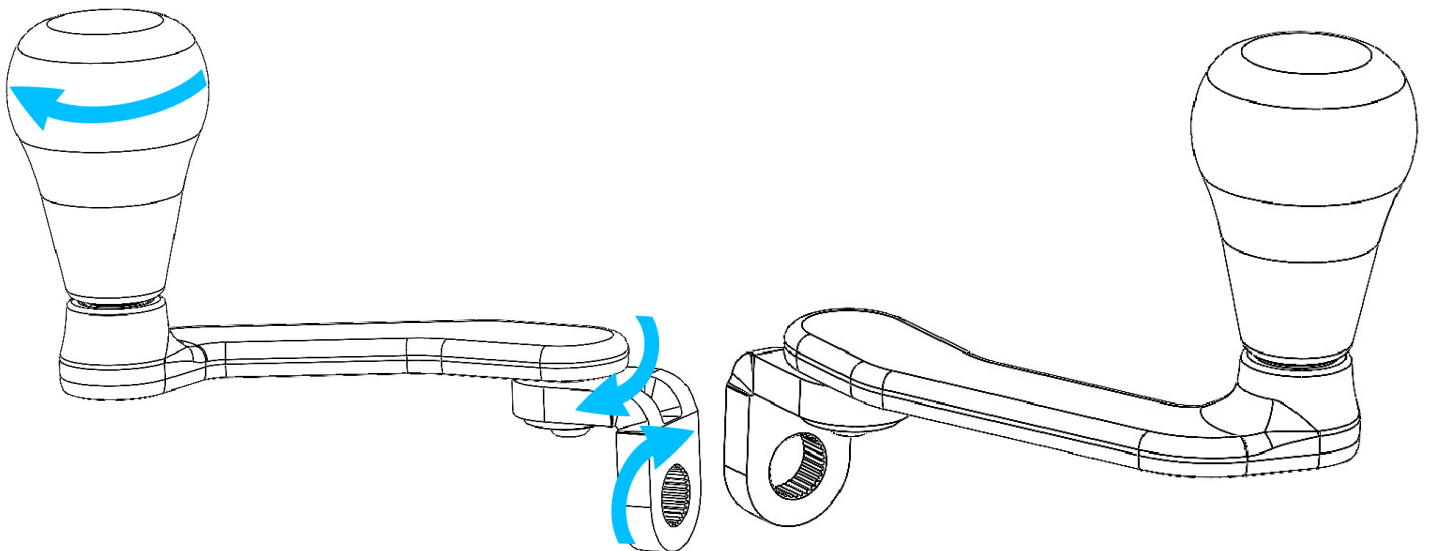

- Compatible with eConnect2 Push Pull
- Available in left and right versions
- 2 adjustable axes
- Left side **Z04297**
- Right side **Z04342**

Push Right Angle Basic Grip

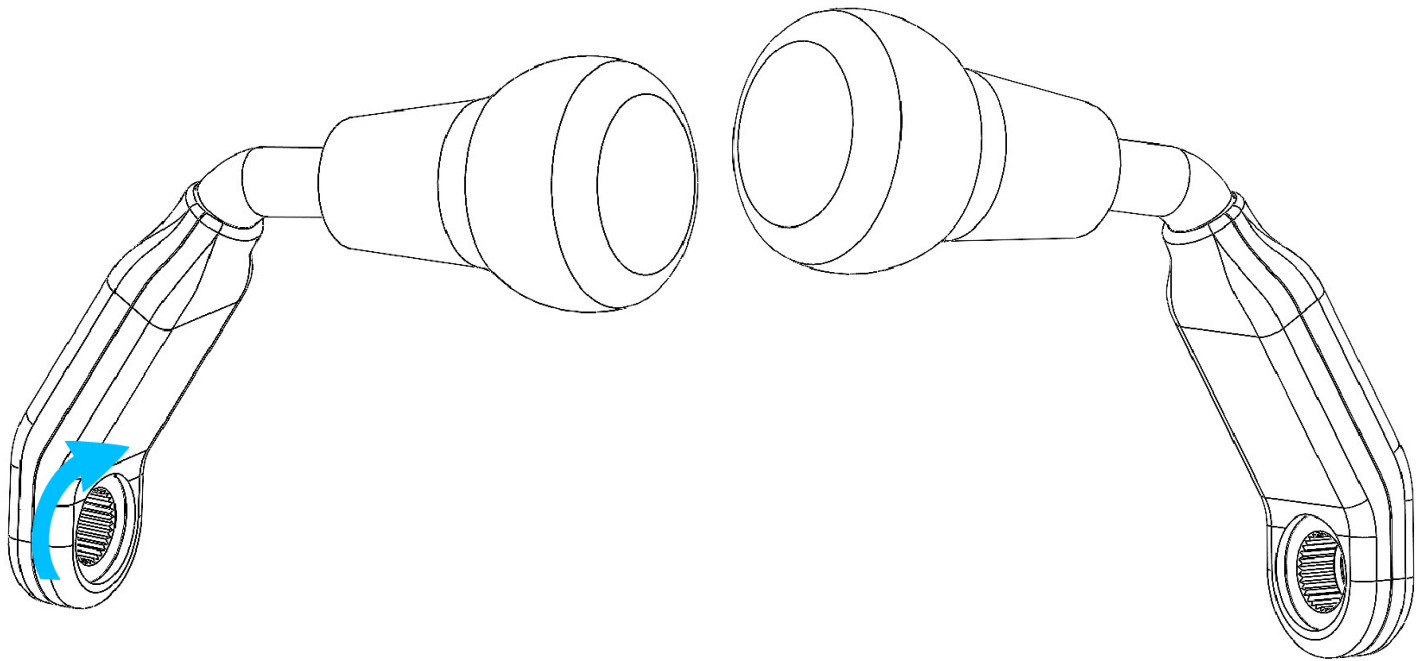

- Compatible with eConnect2 Push Right Angle
- Can be installed on the left or right side
- One adjustable axle
- Left/Right **Z04361**

Premium Horizontal Grip with buttons

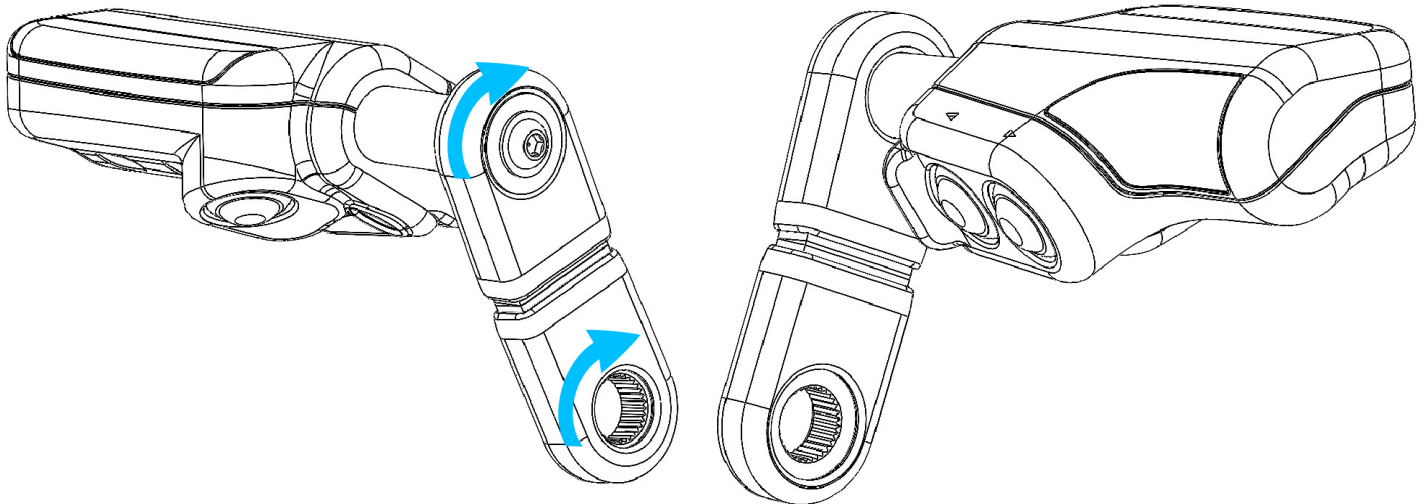

Partnumbers:

- Left **Z04298**
- Right **Z04311**
- Left +20 mm **Z04313**
- Left +30 mm **Z04314**
- Right +30 mm **Z04370**

- Compatible with eConnect2 Push Pull and eConnect2 Push Right Angle
- Available in left and right versions
- 2 adjustable axes
- Ergonomic handle for horizontal gripping with 3 control buttons
 - Left turn signal
 - Right turn signal
 - Horn (freely programmable)

Premium Vertical Grip with buttons

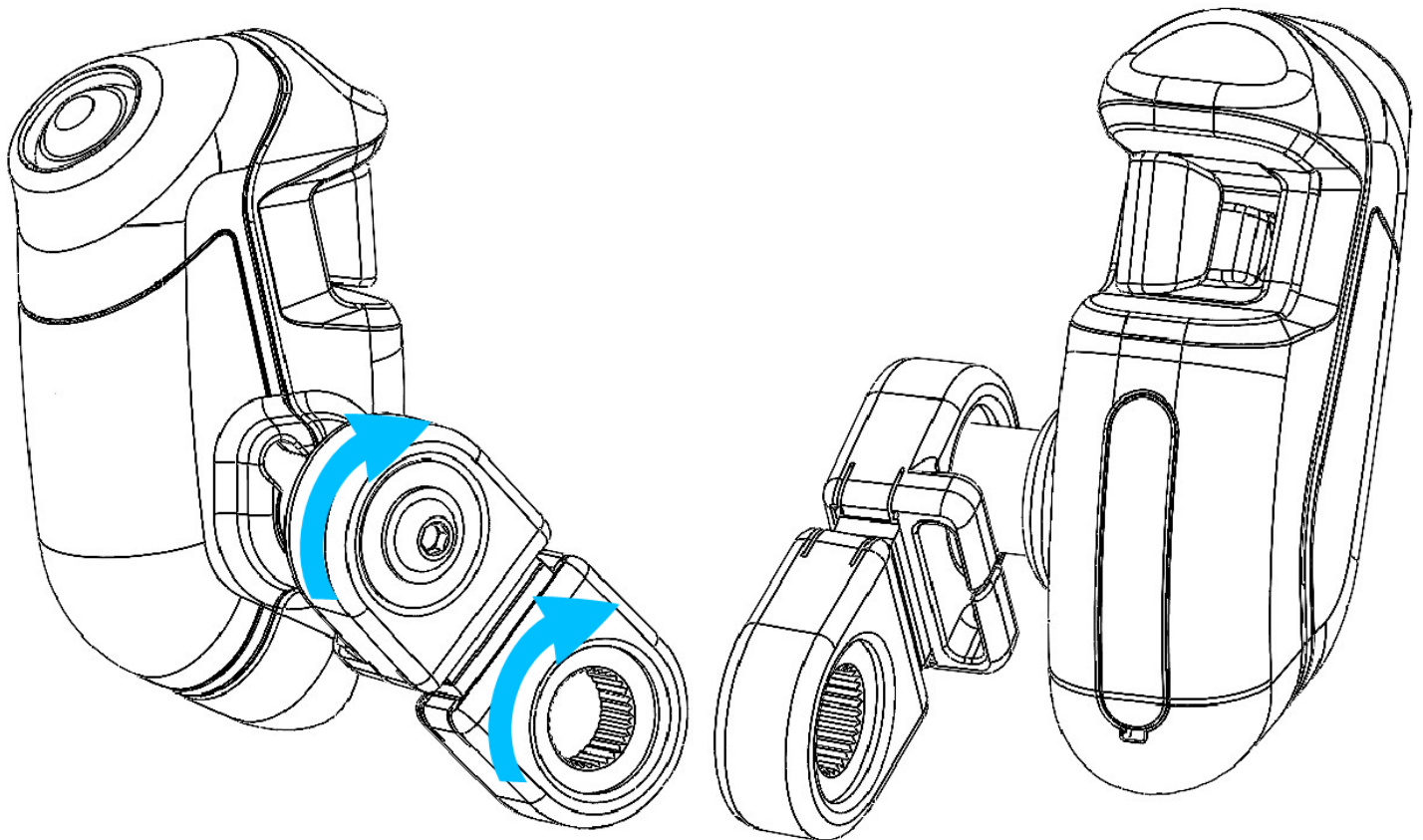

Partnumbers:

- Rechts rastend **Z04335**
- Links rastend **Z04336**
- Rechts tastend **Z04337**
- Links tastend **Z04338**

- Compatible with eConnect2 Push Pull and eConnect2 Push Right Angle
- Available in left and right versions
- 2 adjustable axes
- Ergonomic handle for horizontal gripping with 3 control buttons
 - Left turn signal
 - Right turn signal
 - Horn (freely programmable)

Premium Vertical without buttons

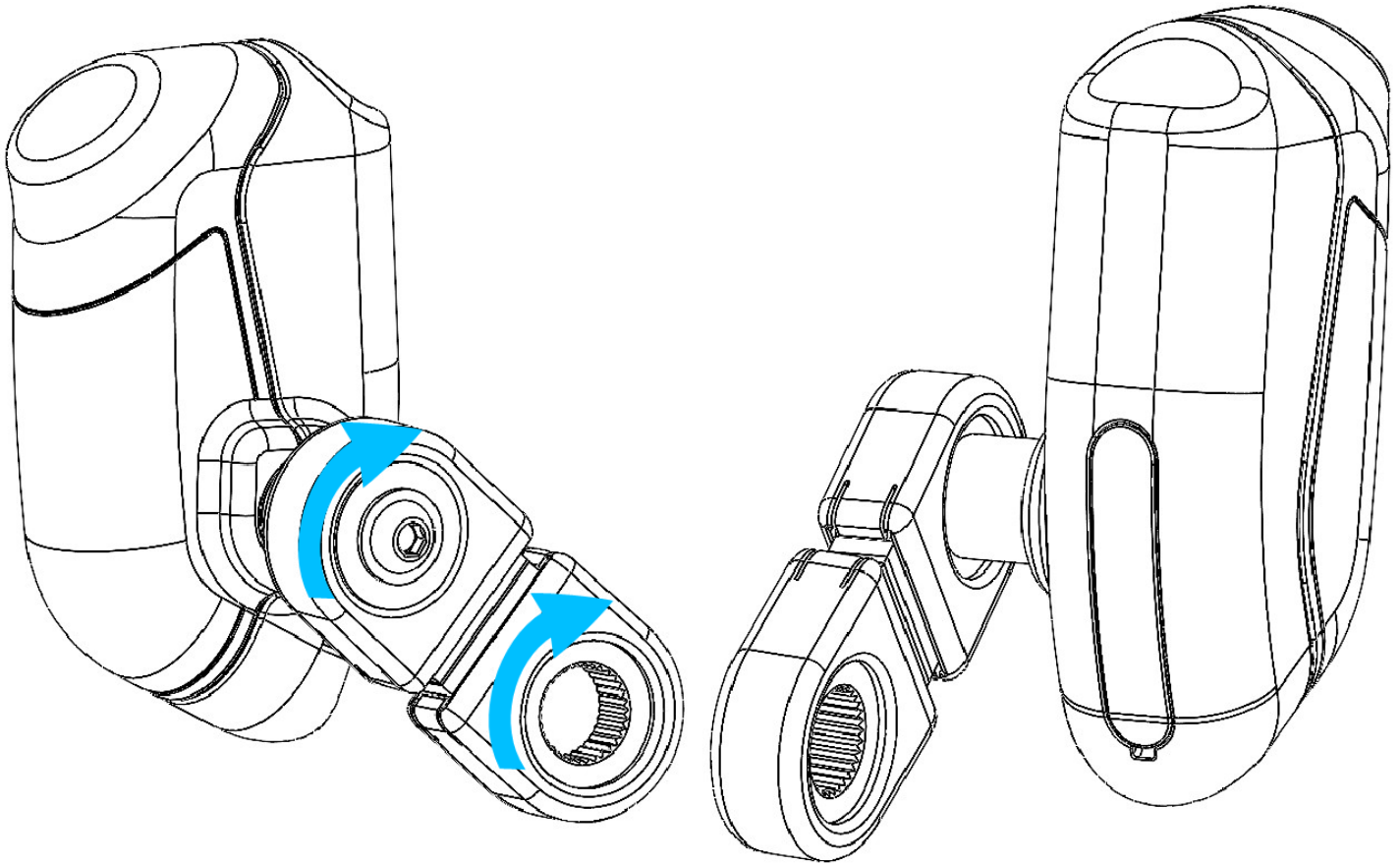

- Compatible with eConnect2 Push Pull and eConnect2 Push Right Angle
- Available in left and right versions
- 2 adjustable axes
- Ergonomic handle for vertical gripping
- Right without buttons **Z04341**
- Left without buttons **Z04340**

Scope of delivery Electronics kit VAS

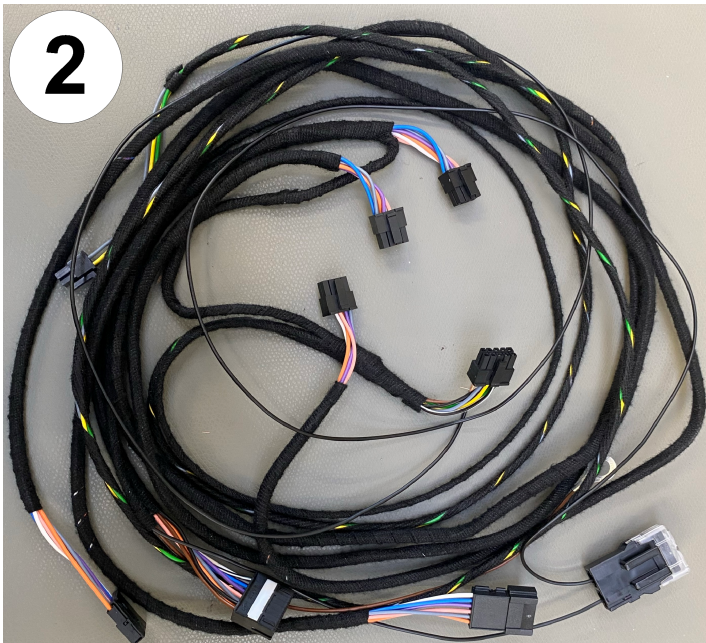

1	VAS control unit
2	VAS cable set
3	Switch with LED

Universal adapter cable set

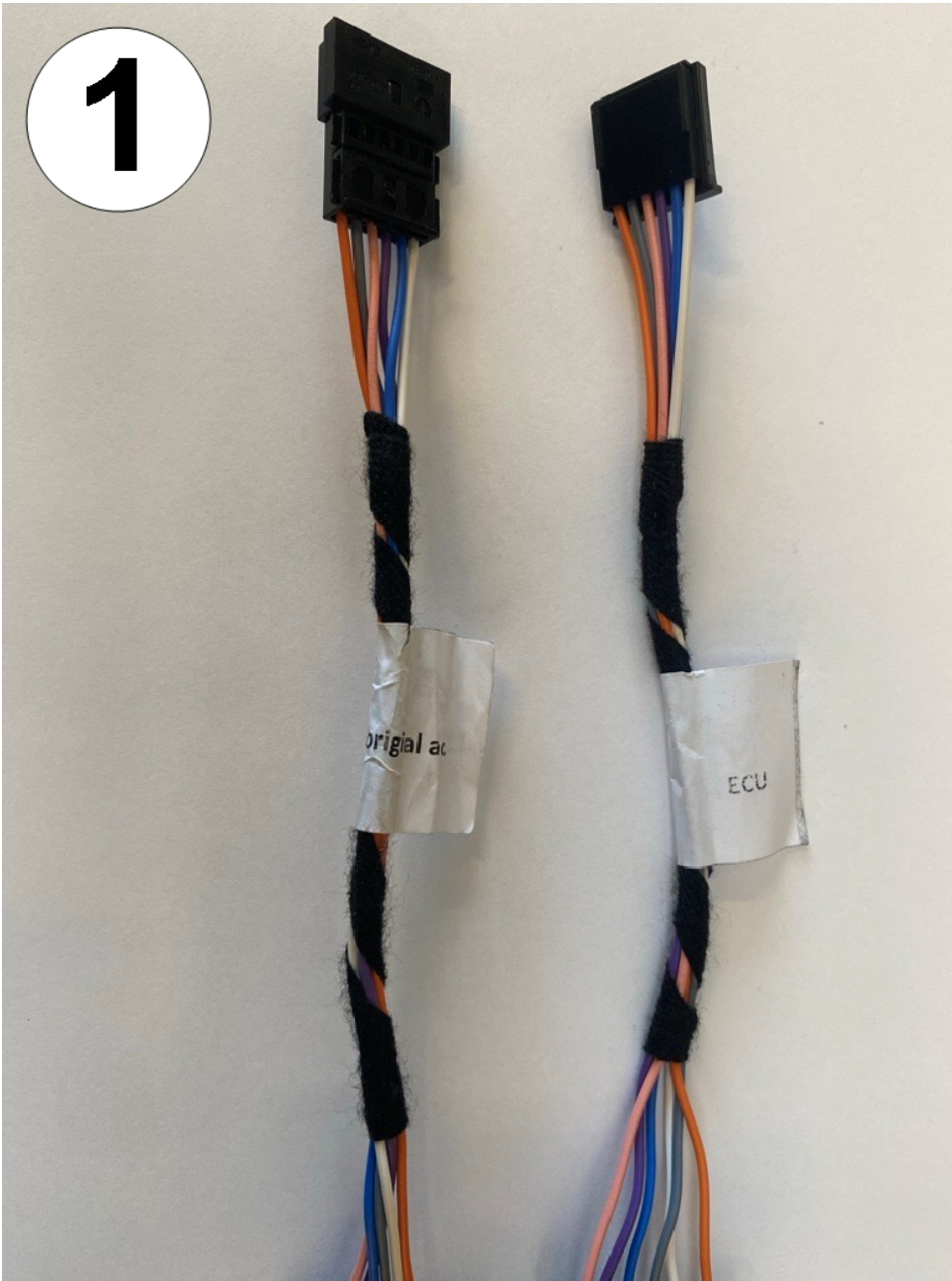

1 | Universal adapter cable set

Intended use

- The hand control is used to operate the accelerator and brake pedals in motor vehicles with automatic transmission.
- It may only be used by drivers with the appropriate disability. The necessity of its use must be noted on the driver's license.
- An installation kit is required to install the hand control.
- This installation kit contains all the parts necessary to install the hand control in your vehicle, as well as the pedals and linkage parts for connection.
- The parts are largely installed at existing mounting points in the vehicle. Drilling work on the vehicle is only necessary in a few exceptional cases.



Please observe the instructions in the installation manual supplied with these mounting kits, as well as the "Installation" section in this operating manual.

Operation

Safety information

- Please read the operating instructions included with your product.
- The driving aid features built-on parts and levers that will restrict the space available in the vehicle to a certain extent once installed.
- When lending the vehicle to another person or when taking it to the workshop, please ensure that you make them aware of the installed product and tell the respective person how to use it.
- For drivers who are not authorised to use the product, the product must be removed or taken out of service.
- Take a moment to familiarise yourself with the converted vehicle.
- This driving aid is easy to operate and its electronic control unit complies with the highest safety standards of the automotive industry.
- The electronic switchover between the original pedal and the driving aid can only be performed in the first six seconds after switching on the ignition.
- Pressing the switch while driving will not affect the function of the driving aid.
- Should the vehicle enter emergency mode during operation, please notify the workshop that the driving aid has been installed and hand over all the installation documentation that goes with it. The responsible repair shop should contact the system manufacturer in case of any doubt ([Veigel hotline](#))



We recommend visiting a driver training area to adapt to the unfamiliar mode of operation.



You have fitted a high-quality, carefully manufactured Veigel driving aid in your vehicle. Observe the following points to make sure your driving aid keeps working properly for a long time to come.

Component	Inspection	Frequency
Brake rods	Permissible play of 1–2 mm	Before setting off on any journey



Arrange for any irregularities to be examined immediately by a workshop.

- For people with limited mobility in their legs, it is advisable to use a pedal cover for the accelerator and brake pedals to prevent uncontrolled operation or blocking of the pedals.
- The decision on the necessity of a pedal cover is made by the responsible expert of a technical inspection service and documented in a report. This report forms the basis for a corresponding entry in the driver's license.
- This pedal cover is not included in the scope of delivery of the hand control or the installation kit. The pedal cover must be ordered separately for the corresponding vehicle type.
- Conversions or additions in the area of the hand control, dashboard, and center console are not permitted. Therefore, mobile phone consoles or similar devices cannot be installed there.

Push pull operating concept

Brake:

Push to brake.

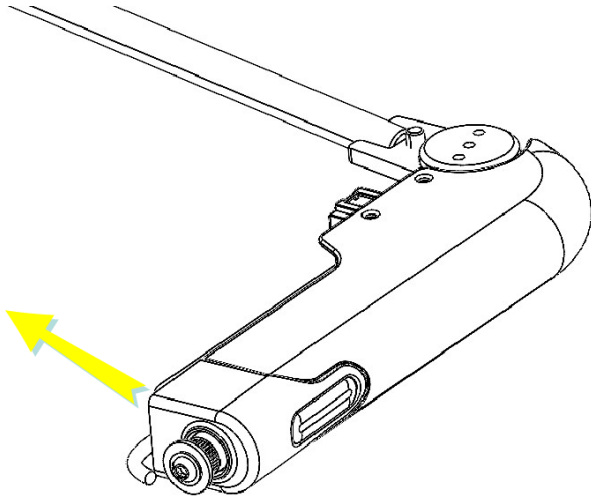

Accelerate:

Pull back horizontally to accelerate.

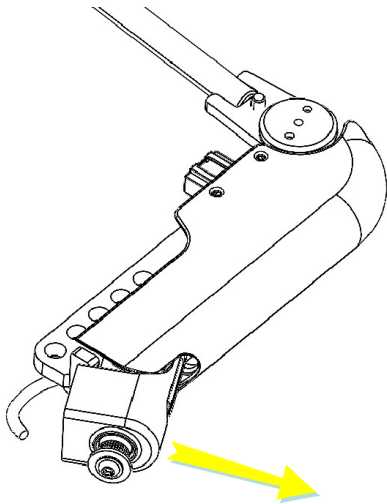

Push Right Angle operating concept

Brake:

Push to brake.

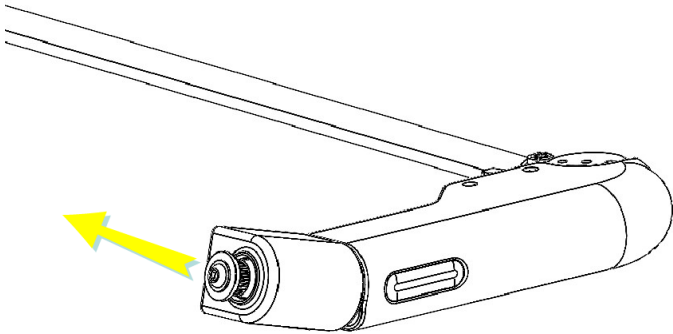

Accelerate:

Press down at a right angle to accelerate.

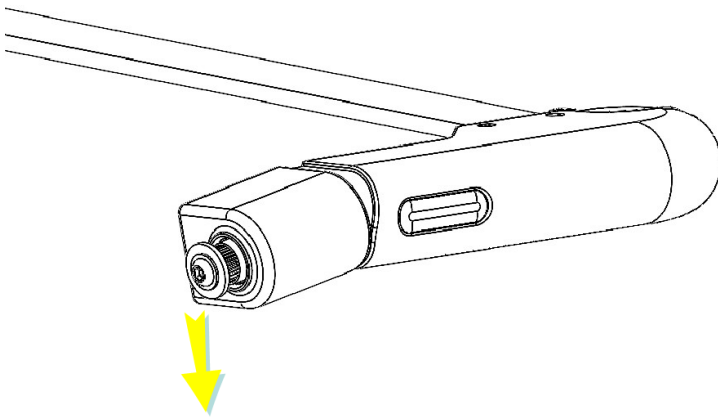

Push Rock operating concept

Brake:

Push to brake.

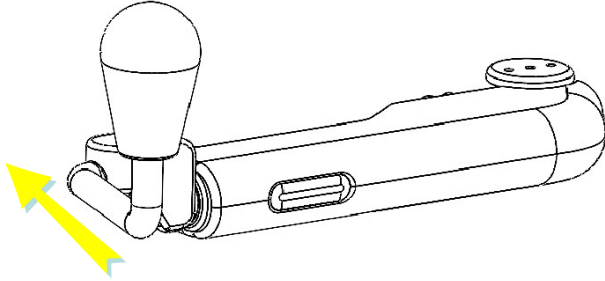

Accelerate:

Pull the throttle lever down toward the driver to accelerate.

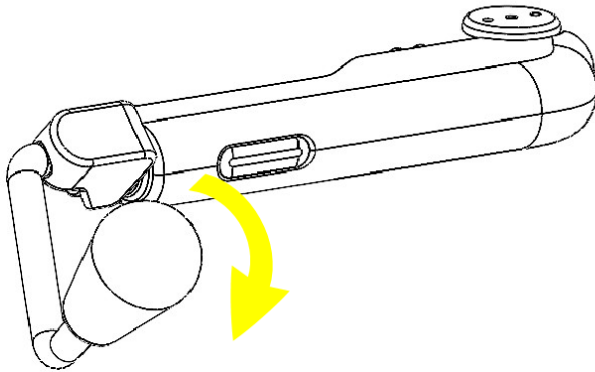

Operation of the electronic switchover VEA



When delivered, the VEA is in mode 1.

- Mode 1:
 - The original accelerator pedal is active each time the vehicle restarts. It is possible to switch the VEA to mode 2 instead.
- Mode 2:
 - The last accelerator pedal used remains stored.
- Change operation mode
 - Switch between mode 1 and mode 2 here.

Mode 1:

1. Turn on the ignition
2. Status LED flashes quickly once (original accelerator pedal active = LED off)
3. Press the button within 6 s to switch the accelerator pedal (**Attention:** This can only be done once, after that the ignition needs to be switched off and switched on again)
4. If driving aid is active, the status LED lights up continuously. Otherwise, the LED goes out and the original accelerator pedal is active.

Mode 2:

1. Turn on the ignition
2. Status LED flashes quickly once (original accelerator pedal active = LED off, driving aid active = LED flashes)
3. Press the button within 6 s to switch the accelerator pedal (**Attention:** This can only be done once, after that the ignition needs to be switched off and switched on again)
4. If driving aid is active, the status LED lights up continuously. Otherwise, the LED goes out and the original accelerator pedal is active.
5. The most recent setting has been saved and preselected for the next start.

VEA mode setting

1. Turn off the ignition.
2. Press the original accelerator pedal > 90% (full throttle), press the button and then turn on the ignition. (Everything at the same time)
3. Press and hold the accelerator pedal and the button for 10 sec.
4. The status LED on the pushbutton starts flashing and indicates the current mode. (See table)
5. Now the button and the accelerator pedal can be released.
6. To switch the mode, press the button. Each press of the button increases the mode by one. When the last mode is reached, the flashing code starts again at mode 0.
7. When the mode is changed, by pressing a button, the LED flashes to indicate the new mode. When the correct mode is reached, wait 30 seconds until the switch stops flashing, then turn off the ignition. The mode is now saved.

Operation mode	Description	Flashing code
0	Test mode: for internal use only	1 sec on – 1 sec off
1	VEA switches to the original accelerator pedal as soon as the ignition is turned on.	1 sec on – 1x flashing – (250 ms on/off) 1 sec off
2	VEA switches to the last accelerator pedal used as soon as the ignition is turned on.	1 sec on – 2x flashing – (250 ms on/off) 1 sec off
3	Driving school mode	1 sec on – 3x flashing – (250 ms on/off) 1 sec off
4	Driving school mode, the last driving condition is activated.	1sec on – 4x flashing – (250ms on/off) 1sec off



The left picture shows the switch with active original accelerator pedal, the right picture shows the switch with active driving aid.

Operation of the electronic switchover VAS



When delivered, the VAS is in mode 5.

- Mode 5:
 - The last accelerator pedal position remains stored.
- Mode 6:
 - The original accelerator pedal is active every time the vehicle is restarted. It is possible to switch the
 - VAS to mode 5.

Mode 5:

1. Switch on ignition
2. Status LED lights up briefly once (original accelerator pedal active = LED off, driving aid active = LED flashes)
3. Press the button within 6 seconds to switch the accelerator pedal (note: this can only be done once; after that, the ignition must be turned off and on again)
4. When the driving aid is active, the status LED lights up continuously. Otherwise, the LED goes out and the original accelerator pedal is active again.
5. The last setting selected is saved and preselected for the next start.

Mode 6:

1. Switch on ignition
2. Status LED lights up briefly once (original accelerator pedal active = LED off)
3. Press the button within 6 seconds to switch the accelerator pedal (note: this can only be done once; after that, the ignition must be turned off and on again)
4. When the driving aid is active, the status LED lights up continuously. Otherwise, the LED goes out and the original accelerator pedal is active again

Mode setting VAS

1. Turn off the ignition.
2. Press the button and then turn on the ignition. (All at the same time)
3. Hold the button down for 10 seconds.
4. The status LED on the control unit will start to glow red; now release the button.
5. Within the first 30 seconds after switching on the configuration mode (status LED flashes), you can set the operating mode. (see table)
6. To switch modes, press the button. Each press of the button increases the mode by one. When the last mode is reached, the flashing code starts again at mode 0.
7. To save the selected operating mode, leave the control on and wait until the status LED flashes green again.

Status LED

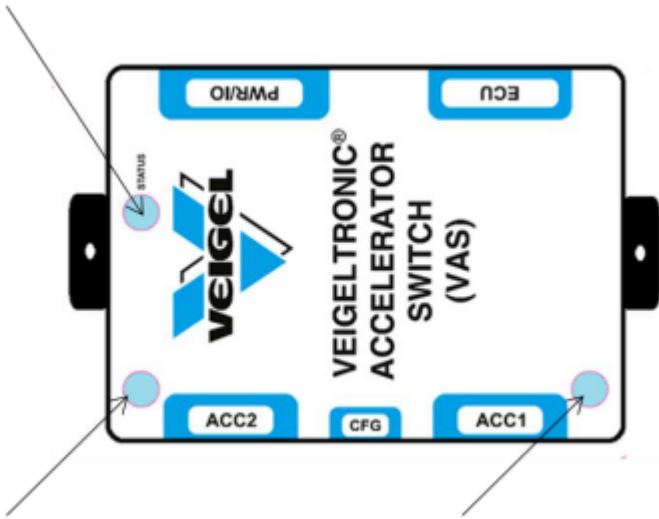

The two blue LEDs of ACC1 and ACC2 indicate the current switching status within the first two seconds after switching.

Operation Mode	Description	Flash code
0	Test mode: For internal use only	1sec on - 1sec off
1	VAS switches to the original accelerator pedal as soon as the ignition is turned on, switching within 6 seconds. (USA only)	1sec on - 1x flashing - 1sec off
2	VAS switches to the last throttle position as soon as the ignition is turned on, switching within 6 seconds. (USA only)	1sec on - 2x flashing - 1sec off
3	VAS switches to the original accelerator pedal as soon as the ignition is turned on, switching within 30 seconds. (USA only)	1sec on - 3x flashing - 1sec off
4	VAS switches to the original accelerator pedal as soon as the ignition is turned on; switching is always possible. (USA only)	1sec on - 4x flashing - 1sec off
5	VAS switches to the last throttle position as soon as the ignition is turned on, switching within 6 seconds. (EU/UK)	1sec on - 5x flashing - 1sec off
6	VAS switches to the original accelerator pedal as soon as the ignition is switched on, switching within 6 seconds. (EU/UK)	1sec on - 6x flashing - 1sec off
7	Not used	1sec on - 7x flashing - 1sec off
8	Driving school mode, dual control is deactivated after ignition change.	1sec on - 8x flashing - 1sec off
9	Driving school mode, the last driving condition is activated when the ignition is switched.	1sec on - 9x flashing - 1sec off
10	Driving school mode, dual control is activated after ignition change, cannot be deactivated.	1sec on - 10x flashing - 1sec off



The left image shows the switch with the original accelerator pedal active, while the right image shows the switch with the driving aid active.

Mounting

Tightening torques

The tightening torques as specified by the vehicle manufacturer apply when converting vehicles using Veigel products. Unless otherwise stated in the text, the usual DIN tightening torques provided in the table below apply for Veigel parts.

Coarse thread			Fine thread		
Dimension	Tightening torque in Nm		Dimension	Tightening torque in Nm	
	8.8	10.9		8.8	10.9
M4	3	4.4	M8x1	27	39
M5	5.9	8.7	M10x1	55	81
M6	10	15	M10x1.25	52	76
M8	25	36	M12x1.25	93	135
M10	49	72	M12x1.5	89	130
M12	85	125	M14x1.5	145	215
M14	135	200	M16x1.5	225	330
M16	210	310			

Safety information

- The product may only be assembled by specialist staff using suitable tools.
- Before starting assembly work, check that the data for your product corresponds to that of the vehicle. Notify us immediately if this is not the case ("Veigel hotline" on page 7).
- Go through the assembly instructions step by step.
- Drill, saw, cut and screw carefully in order to ensure that cables, heating pipes and similar components are not damaged. Slide a plate between the cowl and the lines/cables.
- Carefully seal all screw and drill holes.
- The engine compartment and the area below the dashboard often contain sharp plate edges and the pointed ends of screws, which could cause injury.
- The engine and exhaust may be very hot if the vehicle has been driven immediately prior to installation.
- Do not leave the knife used to cut the insulating mat and the carpet in the footwell.
- Make sure that no cables or other lines are damaged during installation.



Work on the on-board electronics may only be carried out by appropriately trained personnel.



Only trained personnel may work on the airbag system.



Only trained personnel may work on the high-voltage system.



The vehicle should be raised with all drive wheels in the air while configuring/testing the system. Follow the manufacturer's instructions for this.

Adjust bearing

- 1 Insert the hand control with a disc into the main shaft from below.
- 2 The base pin is screwed on from above with another washer.
- 3 The pivot point is then secured from below with an M5x20 cylinder screw.
- 4 The hand control should be adjusted so that it can still turn without any play.

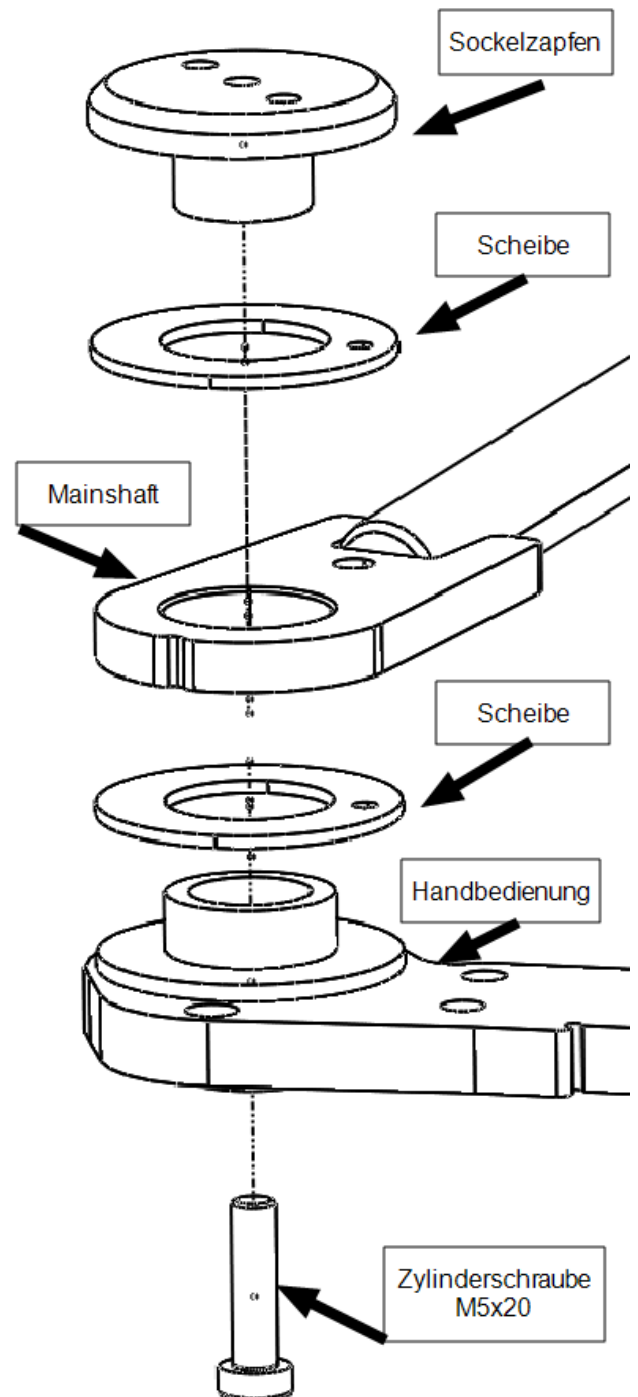

Install brake linkage

- 1 The brake rod is mounted on one of the existing $\text{\O}10\text{mm}$ holes, depending on the installation situation.

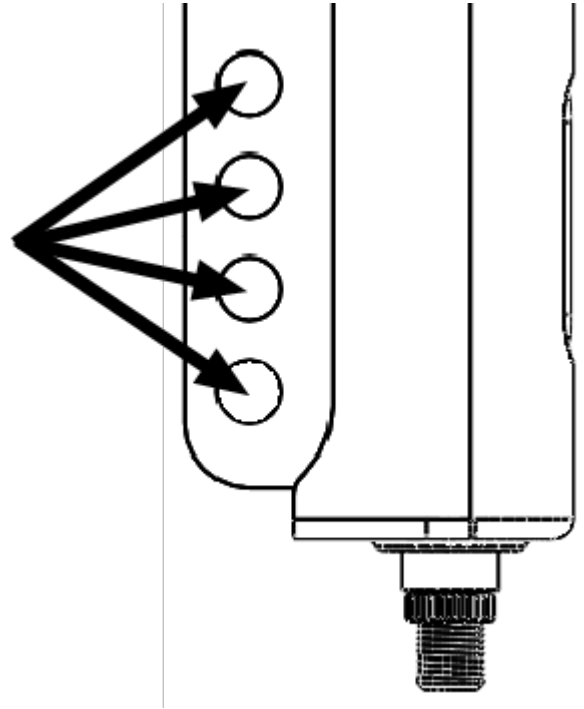

- 2 To do this, screw the adapter to the manual control from below using an M10x16mm cylinder head screw and self-locking nut. The nut must then be covered, as otherwise there is a risk of injury.

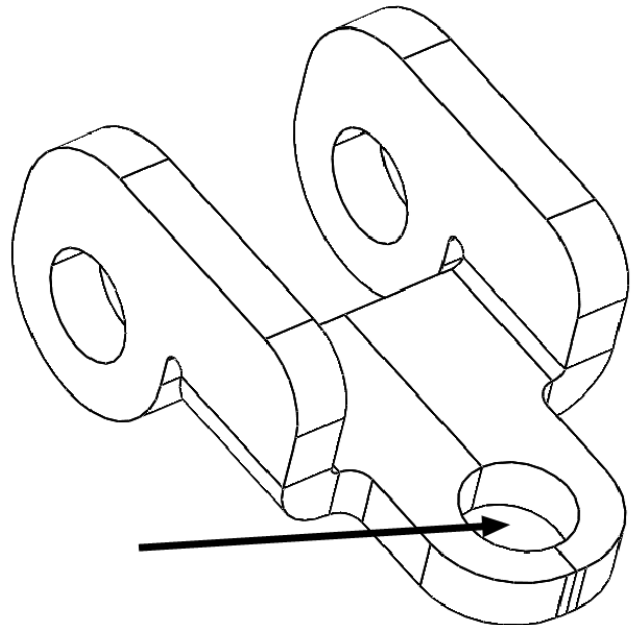

- 3 The M10 ball head is screwed onto one of the two wings of the adapter and secured with a self-locking nut. Alternatively, the ball head can also be used without an adapter.

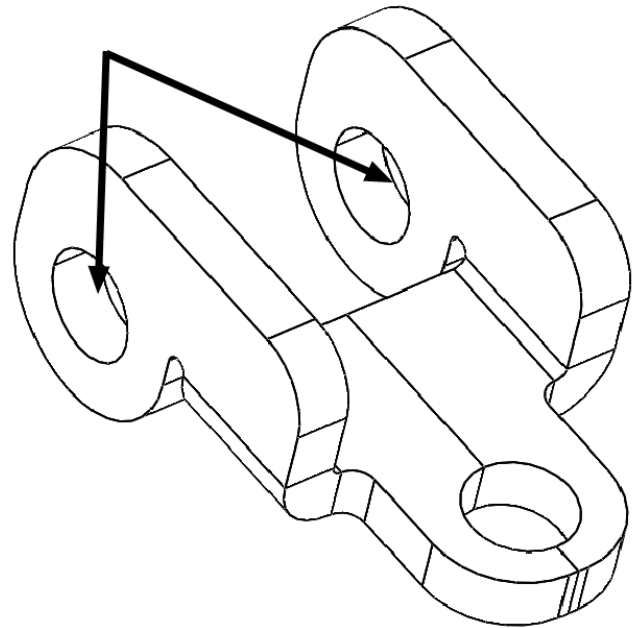

Adjust brake linkage

The length of the brake linkage is adjusted with the engine running using the two M12 lock nuts. The play in the linkage must be set to between 1 mm and 2 mm.

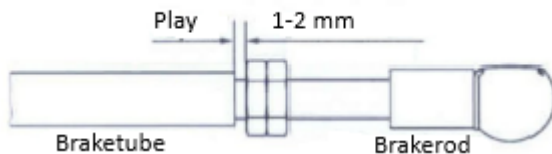

This adjustment must be done with extreme care. Only by adjusting the brake linkage correctly can damage to the brake system caused by a grinding brake be avoided. Please note that the position of the brake pedal changes when the engine is running and when it is stationary.



Only adjust the brake linkage when the engine is running!



Once the linkage has been adjusted, the brake must be applied firmly several times. This allows the pedal connection to settle a little more. The adjustment must then be checked again and readjusted if necessary.



Since brake pipes come in different bends, it is important to align the brake pipes precisely with the manual controls. Therefore, please follow the installation instructions for the mounting kit. Check that the brake linkage is moving freely.

Adjust handle angle



The angle of the handle must be adjusted very carefully to ensure that the hand control functions properly. Careful adjustment not only ensures that the hand control is comfortable to operate, but also ensures that the minimum braking distance can be achieved.

Example Push Rock Basic:

To adjust the handle, first remove the cover over the screw connection. This is attached to the handle and can be removed by lifting it upwards.

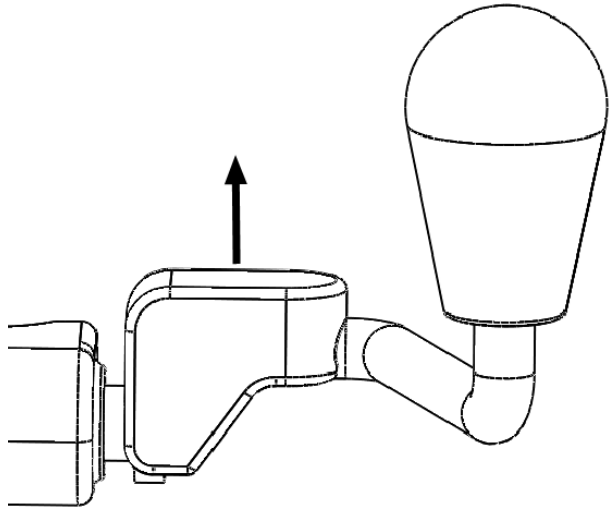

Then unscrew the nut on the end of the shaft.

The handle can now be removed and reattached to the shaft in the required position.

Reassembly is carried out in reverse order.

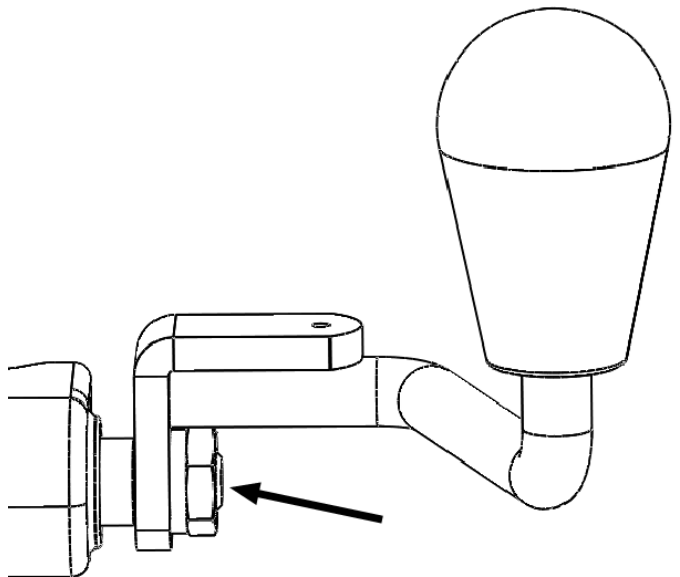

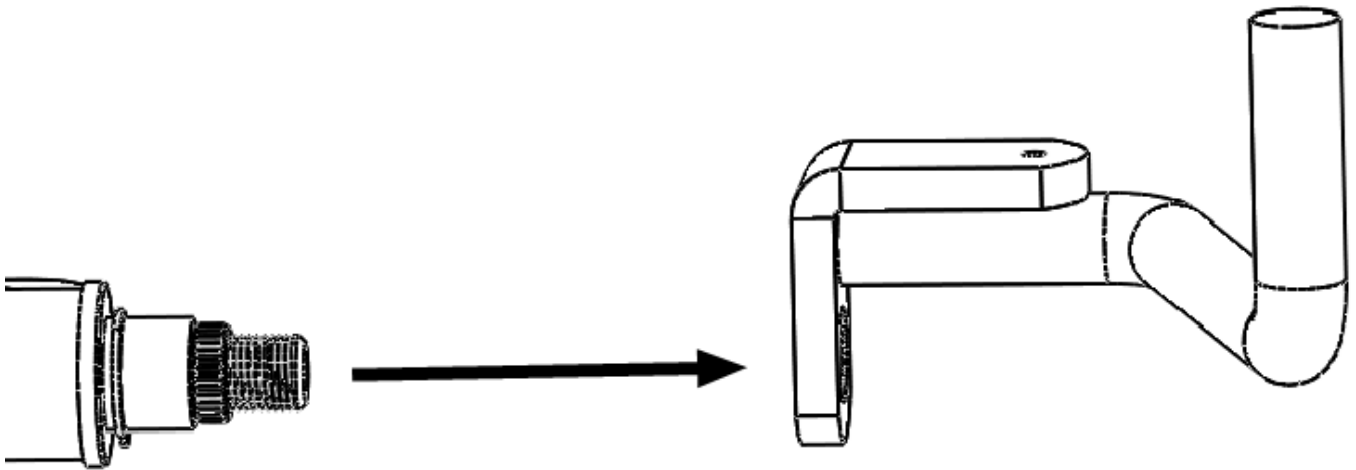

- 2 Connect the plug to the VEA box.
Fasten all loose cables and check that the relevant plugs are seated securely.
- 3 Reinstall the cover in the footwell area on the driver's side dashboard.
- 4 Connect the power supply between the VEA and the vehicle
 - Terminal 15 – black cable
 - Terminal 30 – red cable
 - Earth – brown cable
- 5 It is recommended to disconnect terminals 15 and 30, preferably in the fuse box.
- 6 Drill a hole with a minimum 19.2 mm diameter in a suitable place.
- 7 Note the length of the button and plan for a minimum depth of 40 mm.
- 8 Insert and screw down the button, then connect it to the wiring harness supplied.

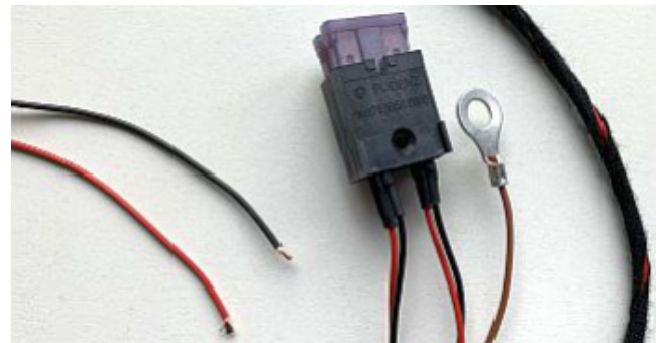

9 Teaching the VEA

- Turn off the ignition
- Plug the TEACH-IN adapter into the black mating connector.
- Turn on the ignition
- Status LED flashes slowly (ready for teach-in).
- Status LED flashes quickly (wiring error; start from point 1 to rectify it)
- Fully depress the original accelerator pedal (hold for approx. 2 sec.)
- Fully depress the auxiliary accelerator (hold for approx. 2 sec.)
- Press the button for approx. 1 s to confirm the teach-in process. (5x slow flashing means teach-in was successful, go to point 10/fast flashing means teach-in was unsuccessful)
- If teach-in was unsuccessful, start from point 1. If the process fails again, perform troubleshooting and, after rectifying the error, go to point 1)
- Turn off the ignition
- Unplug the TEACH-IN adapter
- Turn on the ignition and test the function.

	<p>In Volvo vehicles, the VEA is already programmed when delivered. If this does not work, follow the procedure described below.</p>
---	--

Teaching the VEA

- Unplug both fuses from the VEA control unit.
- Plug in the Teach In adapter.
- Get into the driver's seat, press the brake pedal and hold it down until the Teach In process is complete.
- Briefly shift into "D", then back into "P" (only then will the second signal be available on the accelerator pedal).
- Insert fuse (Teach In process starts)
- Press the original accelerator pedal all the way down



- Briefly press the driving instructor's accelerator pedal
 - Briefly press the button
 - If the Teach In is successful, the LED flashes 5 times briefly (in Mode 3, it goes out immediately); if it is not successful, it flashes rapidly
 - The brake pedal can now be released
- 10 Set the correct mode as described in "Operation of the electronic switchover VEA" on page 27.
- 11 Checking the VEA function
- Start the vehicle. The VEA should be adjusted to the original accelerator pedal. Make sure that the original accelerator pedal is active and working correctly. Switch the vehicle off.
 - Start the vehicle again and press the switchover button once for 1 second.
 - If the VEA cannot be switched on, check the mode that is set.
 - If controlled accelerating is not working properly, check all plugs and make sure that the cabling is correct.
- 12 Before finally laying the cables, check that the two contact housings have been assembled on the accelerator pedals correctly. If they have not, replace the contact housings on the accelerator pedals.
- 13 Securely fasten the VEA in the vehicle, then lay and fasten the cables, preferably with cable ties.
- 14 Make sure that all cables have been laid pinch-free and abrasion-free.
- Make sure that the VEA and cables do not collide with the moving parts.

Schematic representation of the cable set VAS

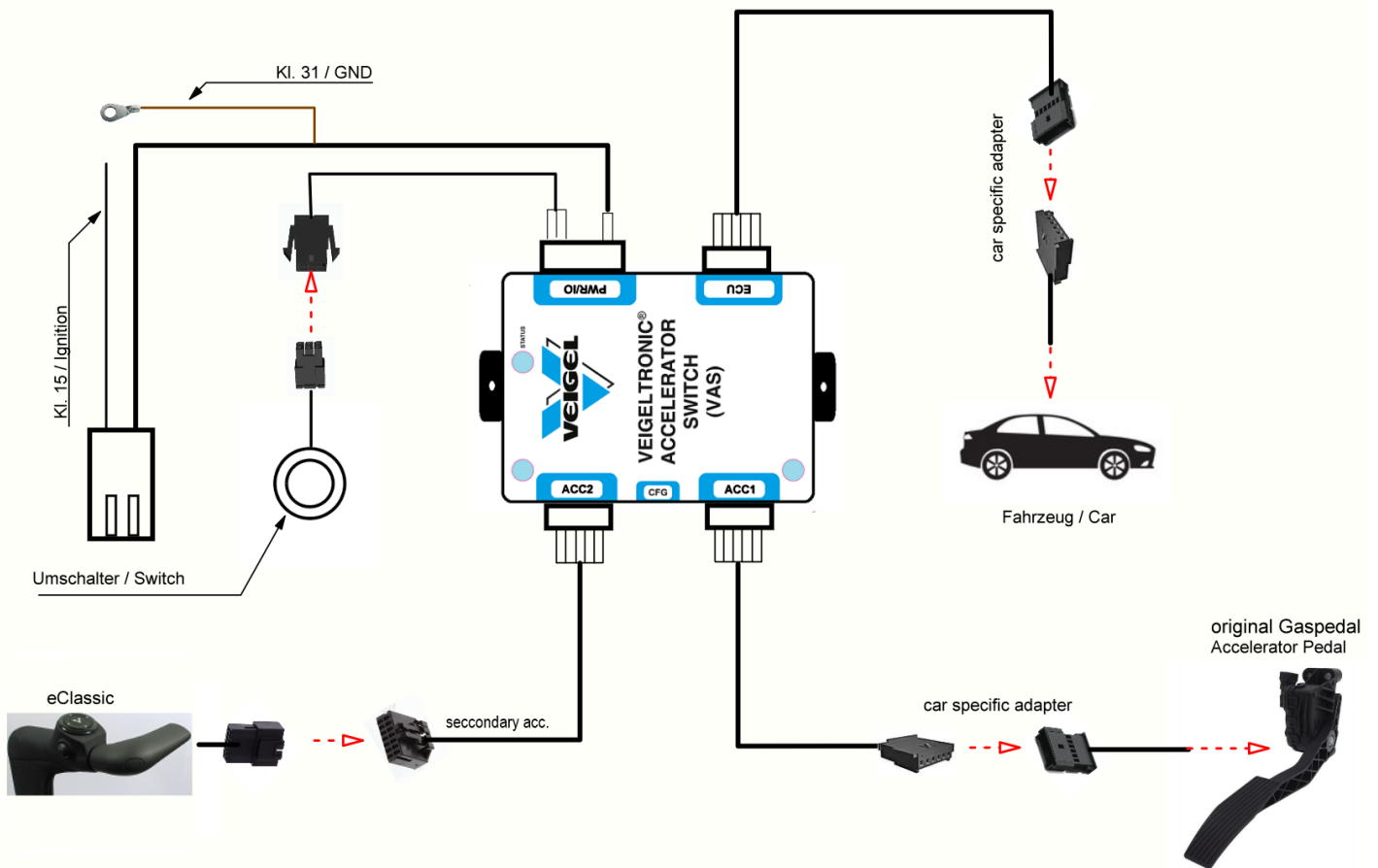

Installation of the VAS control system

- 1 Connect the plug connection to the VAS box. Secure all loose cables and check that the relevant plug connections are firmly in place. Reinstall the trim in the footwell area on the driver's side of the dashboard.

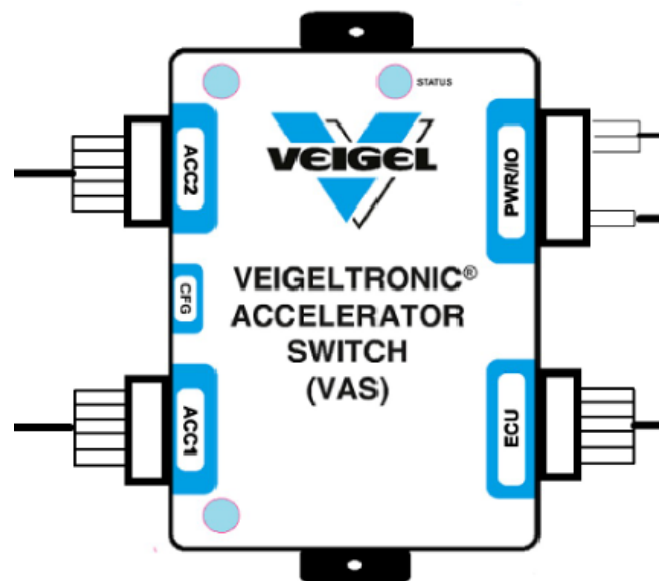

- 2 A hole with a diameter of at least 19.2 mm must be drilled in a suitable location.
The length of the sensor must be taken into account. A depth of at least 40 mm should be planned.

- 3 After inserting and screwing in the button, it must be connected to the supplied cable harness.

- 4 Connect the power supply between the VAS and the vehicle:

- Terminal 15 - black cable
- GND - brown cable

It is recommended to disconnect terminal 15 in the fuse box.

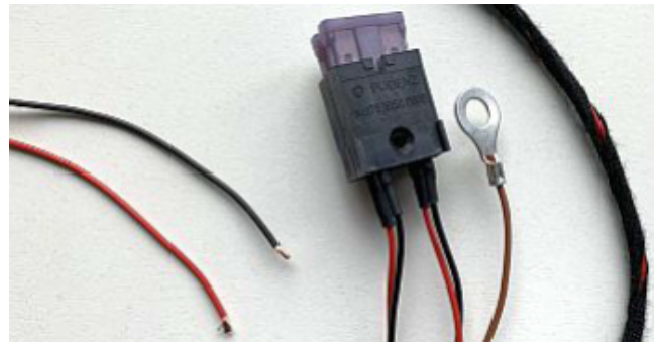

- 5



The VAS control does not need to be programmed.

The mode that always activates the last pedal pressed is automatically active.

Function test VAS

1. Start the vehicle. The VAS should be set to the original accelerator pedal. Ensure that the original accelerator pedal is active and functioning properly. Switch off the vehicle.
2. Restart the vehicle and press the switch button three times within a time window of five seconds to change the pedal.
3. If controlled acceleration does not work properly, check all plug connections and ensure that the wiring is correct.

Notes

Disassembling the product

- Disassemble the product by following the assembly steps in reverse order.
- After disassembly, the screw connections in the vehicle are to be assembled with original fastening parts.
- All bore holes must be sealed professionally.
- The electronic components must also be removed completely.

Disposal



Always comply with national and regional waste disposal directives.

We ensure that the majority of the materials used to make our products are recyclable, right from the design phase. The packaging consists of cardboard boxes, paper and, in some instances, films that can be handed in at recycling centres or public recycling stations.

In case of uncertainty, please contact your county waste consultancy department.

Functional check

When the assembly is complete, check it has been done properly against the installation record.

Check the installed product for correct functioning when stationary and during a test drive:

When checking the function, make sure that all components run smoothly and all the moving elements move freely.

Transport and storage



Transport and storage are only permitted in the original packaging.

Reusing the product

- Before starting assembly work, check that the data for your installation kit corresponds to that of the vehicle.
- Notify us immediately if this is not the case ([Veigel hotline](#)).
- Inspect the product for wear and replace parts with genuine Veigel parts if required. When placing an order, state the order and factory number of the product aid as shown on the type plate.
- If you change the vehicle, all connections to the original pedals must be replaced with new parts.

Maintenance and care



Maintenance and repair work on the products may only be performed by authorised and appropriately trained staff.



Arrange for functional faults to be remedied immediately by a specialist workshop.

Every 10,000–15,000 km

Action	Parts
Grease or oil	Do not lubricate metal joints, ball joints or bearings
Adjust and tighten	All screw connections that ensure safe installation in the vehicle.
Inspect	All settings described in these instructions.
Correct, tight fit	All plug connections
Function	LED on button



These jobs can be integrated into the customer service.

Installation record

Product group REHAMOTIVE					
Customer			Order number		
Date		Time from		mechanics	

Car		Part Nr.	
model code		Serial Nr.	
VIN		TYPE	
licenseplate			

OK	n.a	Technical inspection	Inspection of built-in components
		All screws tightened and sealed	BHA Classic hand control
		Clamps/connection parts fixed	BZD Compact hand control
		All parts are movable. Parts move smoothly / Positioning is stable.	-VC with Veigelcommander
		Lever/linkage free-moving	-BS with turn signal switch
		Reaching full throttle/idle positions	BBL Turn signal lever relocation
		Pull and push rods countered / secured / safety devices installed	BDK Steering wheel knob small / large
		Ball heads equipped with safety devices	BLG Steering fork / steering trident
		All joints lubricated	BEH Electric handbrake
		Covers installed	BLF Leftfootaccelerator LFG 1
		Brake linkage 1-2 mm play	BLF electronic Leftfootaccelerator LFG 5
		All cables laid without chafing	BPA Pedal attachment Accelerator/Brake/Clutch
		Clean interior	BPS pedal cover
		Type plate attached (conversion, development, etc.)	BVS Seat adapter / seat rail extension
		Sticker attached	BWS wiper lever relocation
			SUH Transfer aid Driver's side / Passenger side
		Airbag deactivated	BMC MyCommand
		Yes (confirmation form "Airbag deactivation")	Removed original vehicle parts loaded
		No	

Controlled by: _____ (mechanic)

Special features/additions to the order	Checklist
	Rotary knob mounted or waiver
	Seat travel stop removed
	user manual
	All documents – vehicle registration certificate, etc.
	test drive

signature: _____

Approval



Kraftfahrt-Bundesamt

DE-24932 Flensburg



MITTEILUNG

ausgestellt von:
Kraftfahrt-Bundesamt

über die Erteilung einer Genehmigung
eines Typs einer elektrischen/elektronischen Unterbaugruppe nach der
Regelung Nr.10 einschließlich Änderung Nr. 05 Ergänzung 01

COMMUNICATION

issued by:
Kraftfahrt-Bundesamt

concerning the granting of an approval
of a type of electrical/electronic sub-assembly with regard to
Regulation No.10 including amendment No 05 supplement 01

Genehmigungsnummer: E1*10R05/01*8889*00
Approval number:

1. Fabrikmarke (Handelsname des Herstellers):
Make (trade name of manufacturer):
Haberl Electronic GmbH & Co. KG

2. Typ:
Type:
1E0844 VEA

Ausführung(en):
Version(s):
Entfällt
Not applicable

Handelsbezeichnung(en):
General commercial description(s):
VEA (Veigel Elektronik Accelerator)

3. Merkmale zur Typidentifizierung, sofern am Bauteil vorhanden:
Means of identification of type, if marked on the component:
Typbezeichnung
Type designation

R10 E1*10R05/01*8889*00



Kraftfahrt-Bundesamt

DE-24932 Flensburg



MITTEILUNG

ausgestellt von:

Kraftfahrt-Bundesamt

über die Erteilung einer Genehmigung
eines Typs einer elektrischen/elektronischen Unterbaugruppe nach der
Regelung Nr.10 einschließlich Änderung Nr. 05 Ergänzung 01

COMMUNICATION

issued by:

Kraftfahrt-Bundesamt

the granting of an approval
of a type of electrical/electronic sub-assembly with regard to
Regulation No.10 including amendment No 05 supplement 01

Nummer der Genehmigung: **E1*10R05/01*8440*00**

Approval No.:

1. Fabrikmarke (Handelsname des Herstellers):
Make (trade name of manufacturer):
Veigel GmbH + Co. KG
2. Typ:
Type:
VAS

Ausführung(en):
Version(s):
entfällt
not applicable

Handelsbezeichnung(en):
General commercial description(s):
Veigeltronic® Accelerator Switch
3. Merkmale zur Typidentifizierung, sofern am Bauteil vorhanden:
Means of identification of type, if marked on the component:
Typbezeichnung
type designation